

geçit

Geçit was a 5-day workshop aimed to introduce students of architecture and design to designing and constructing with wood.

It took place at the Faculty of Arts and Design, Izmir University of Economics, at the neighborhood of Balçova, located in Izmir, Turkey.

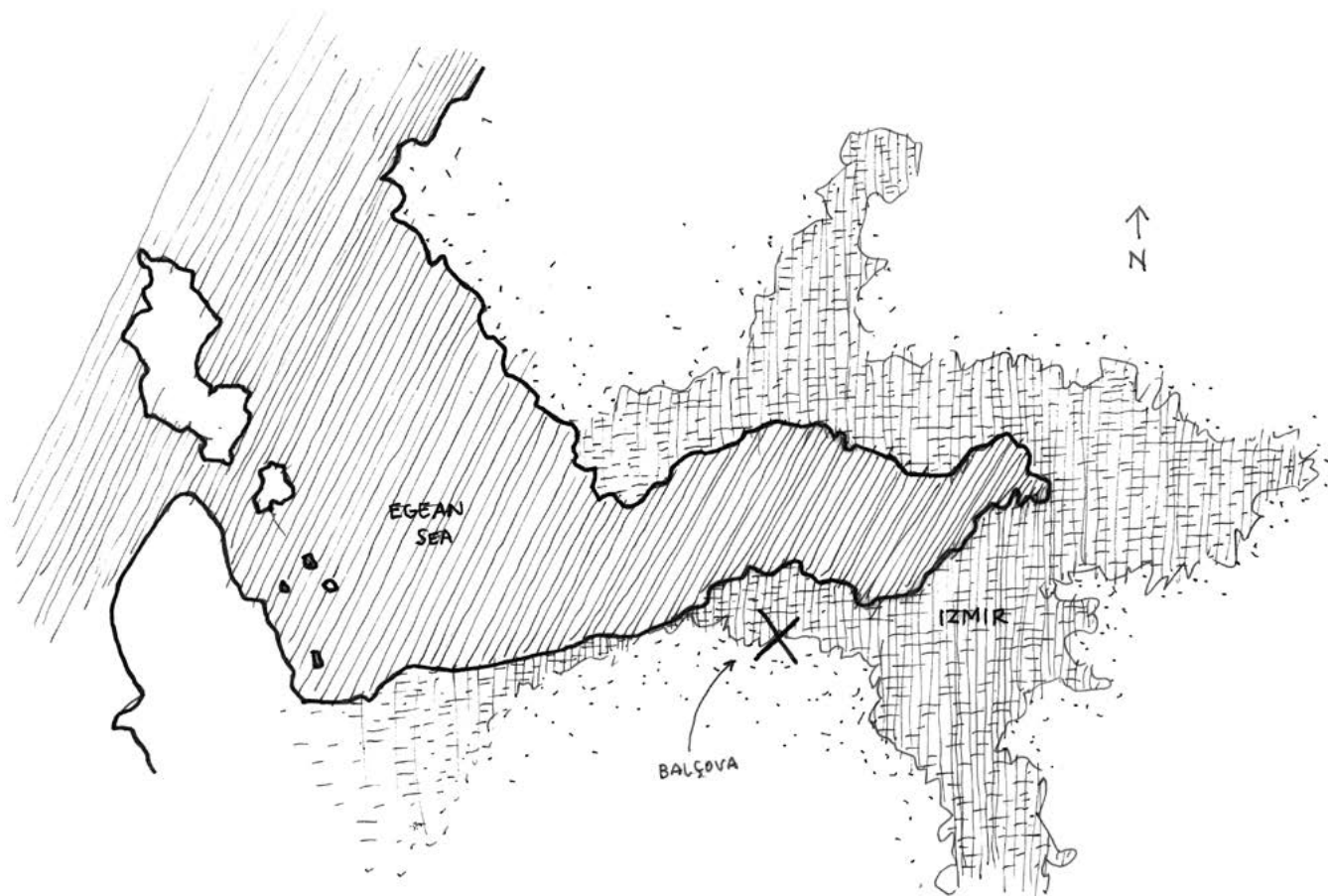
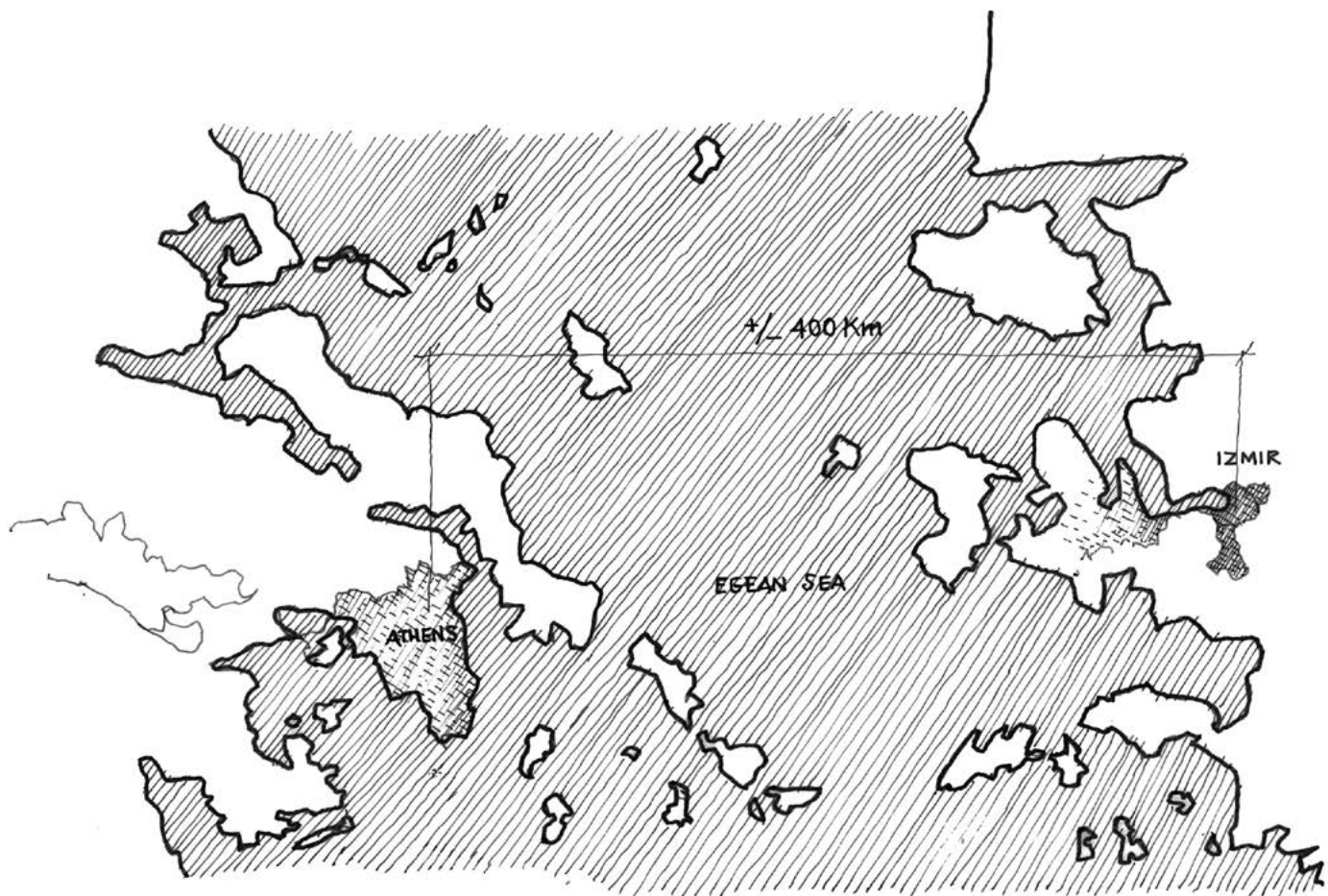

The workshop's **planning**, was established as follows, with a daily schedule starting at 9.30am and finishing at 18.30pm.

How it developed, is described -day by day- in the following pages of this document.

DAY 1

CAMPUS WALK

INSTALLATION

REFERENCES

DAY 2

PLAN

FRAME

COMPONENTS

DETAILS

DAY 3

WORKSHOP

DIMENSIONING

JOINERY - MARK-UP

DRILLING

DAY 4

BUILD-UP

FRAMES

FABRIC DIMENSIONING

DAY 5

ASSEMBLY

SEATING

POSITIONING

FABRIC INSTALLATION



DAY 1

Day one was **a mix of discoveries**. Students meeting the tutors first time in the morning, followed by a campus walk with the aim of finding common spaces that had gone unused and could potentially be reactivated with a simple intervention.

Two site alternatives were quickly identified.

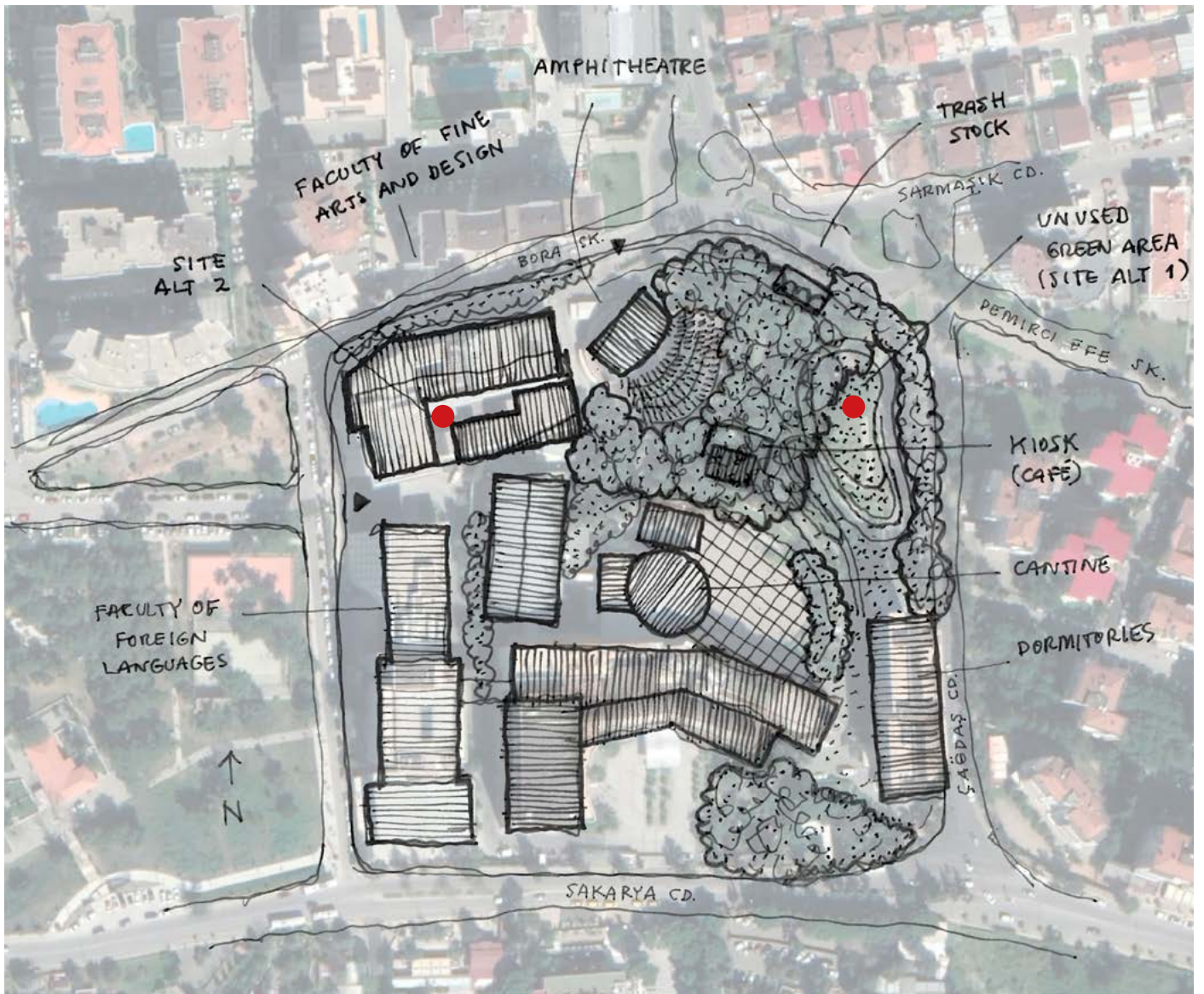

Alternative 1

A space next to the dormitories and a bit to the side and lower in relation to main circulations (which are connected to the eatery, an amphitheater and the main faculty buildings).

The place used to have trees that where at some point taken down, letting the site to the open and making it therefore less attractive and uncomfortable for activities such as meeting, resting or being protected from the intensity of the sun.

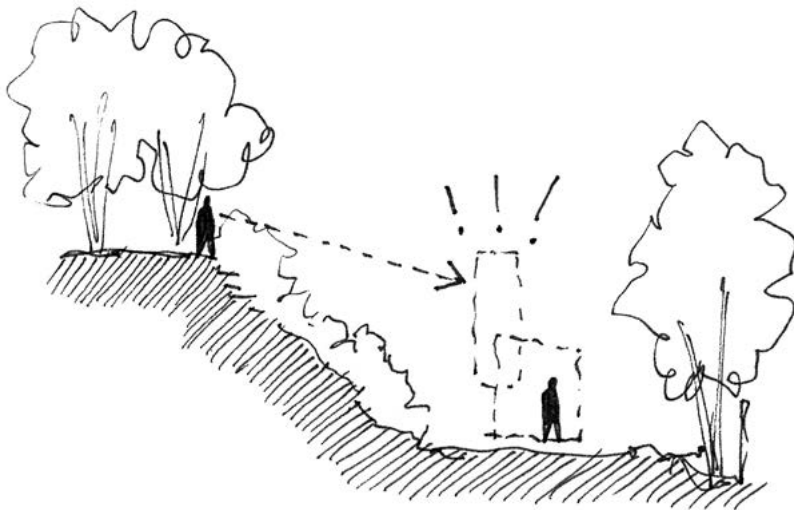
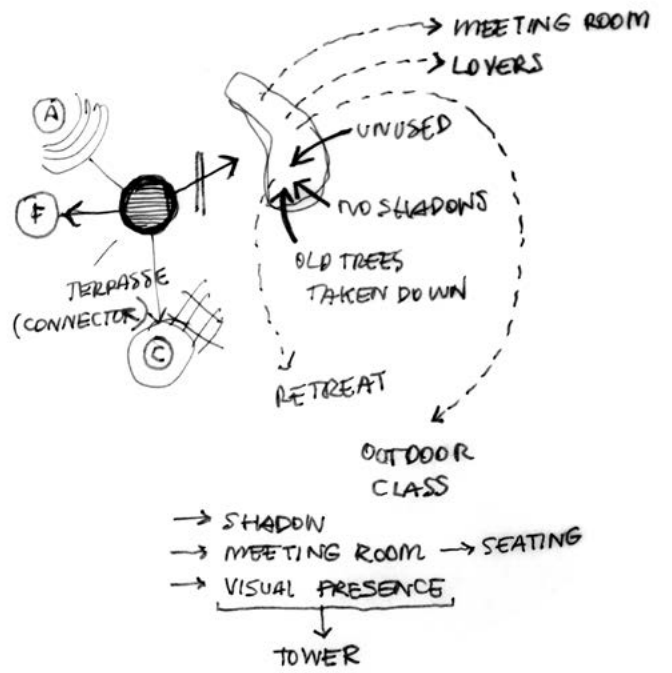
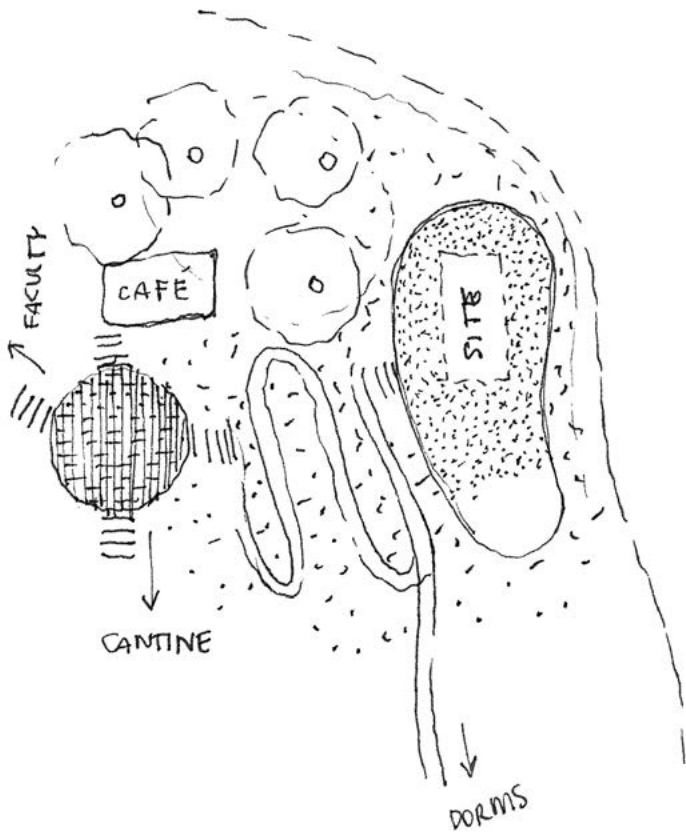

Alternative 2

A space of transition in between the arts and design faculty buildings, close to the main campus entrance and related to diverse leisure programs such as a café, an exhibition space, and lecture rooms. Strategically close to the workshop where the structure's components were going to be prepared.

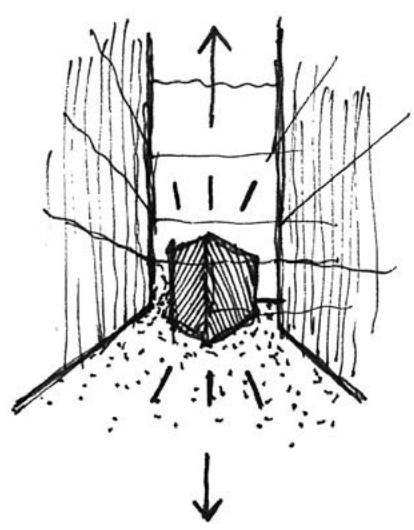
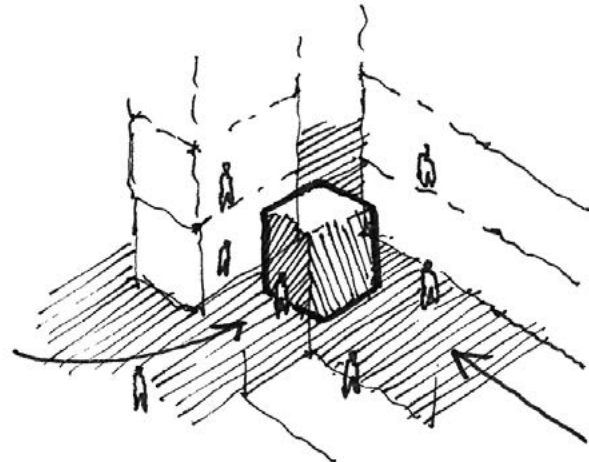
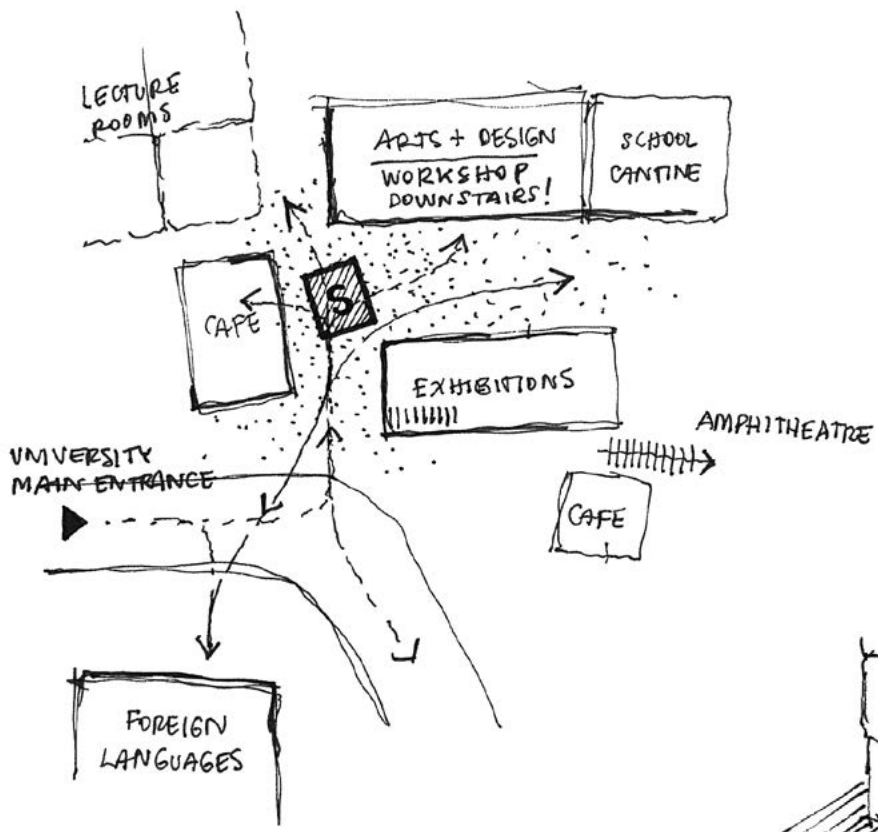

- SHAADON
- PASSAGE
- TRANSITION
- PAUSE
- SEATING / MEETING
- CLOSE TO WORKSHOP FOR BUILD-UP

The other half of the day continued with the analysis of a couple of examples that aimed to introduce students to the notions of **components, structure, and details**, and how the combination of those was to be put together to build a structure in a few days.

To reinforce this analysis, an intuitive exercise was put into action with a series of **canvas easels** that were found on the corridors of the art school. These were then taken outside to a roof terrace and disposed parallel in two lines of 5, then attached to an agriculture mesh measuring 11x3,5m. The result was a 20 minutes installation with variables tested in each easel and a fabric waving under the action of the wind.

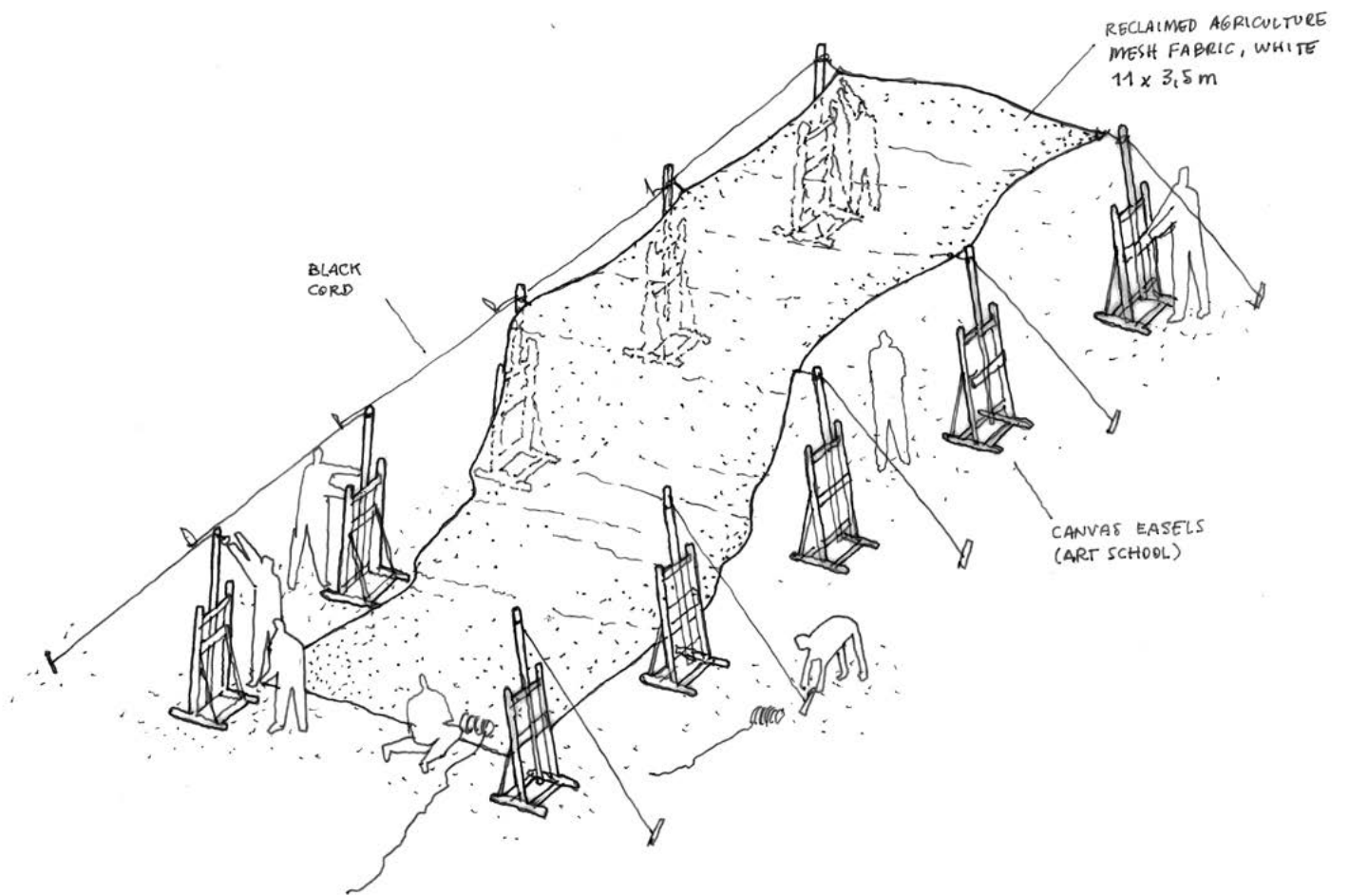

EXERCISE EASELS + FABRIC

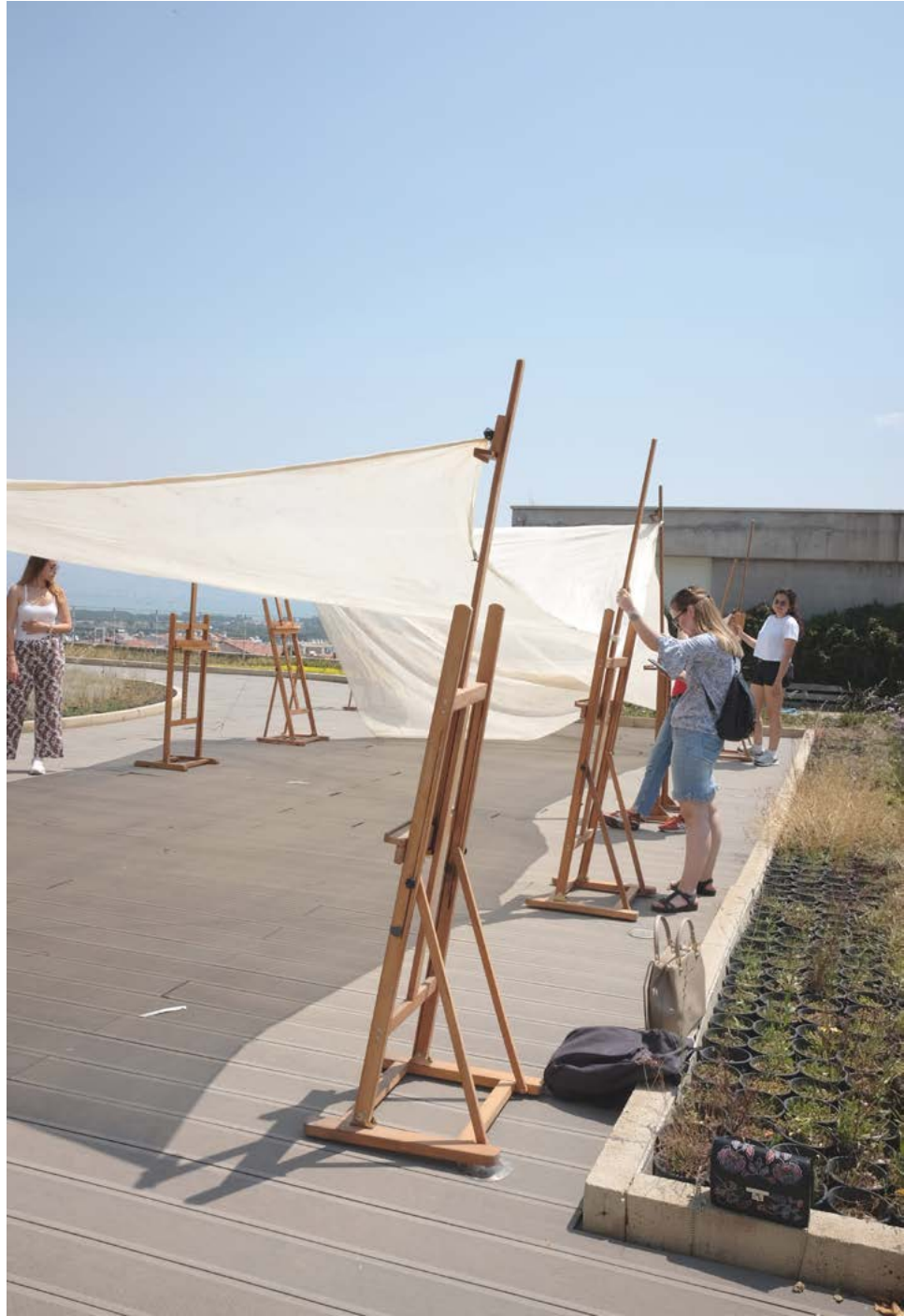

REF 01 / Gartnerfuglen + Mariana de Delás / **Grooming retreat** / Mallorca, Spain 2015



REF 02 / República Portátil / **Pabellón CCP** / Concepción, Chile 2016





DAY 2

Day two was focused on discussing the **multiple possibilities** for the structure, defining its simple program (meeting point + shade + seating + verticality as a spatial pronouncement), and its dimensioning.

First on site, later on scale models, sketches and technical drawings.

By the end of the day a frame was to be determined, and then a base module was to be built in a 1:5 model. This model was to be used as a starting point for day 3.

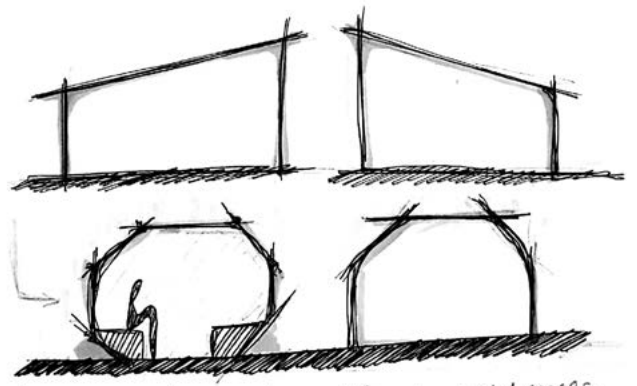

• human comfort and positive and negative spaces.

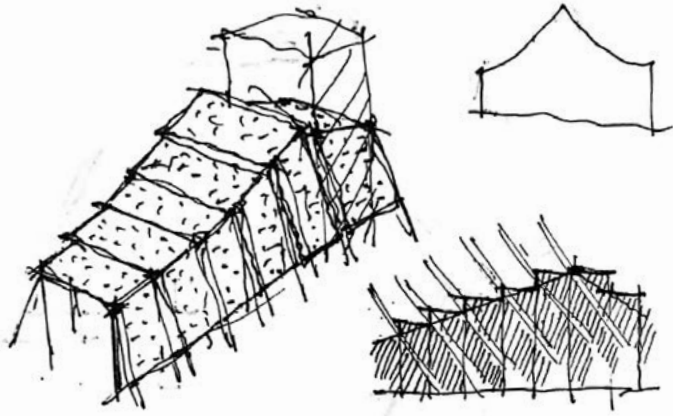

idea of tower

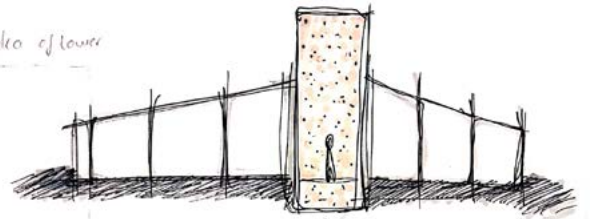

figuring out place.

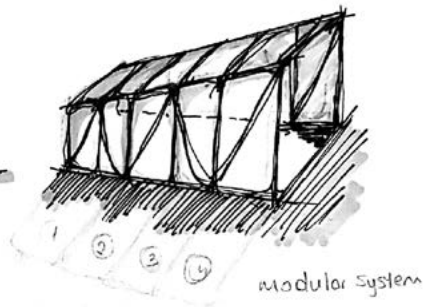
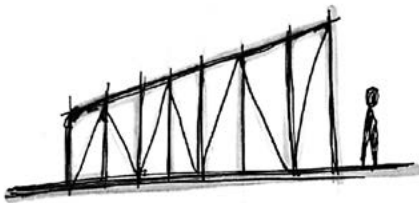
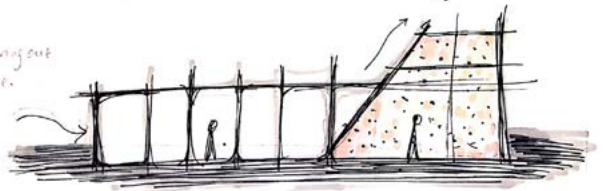

modular system

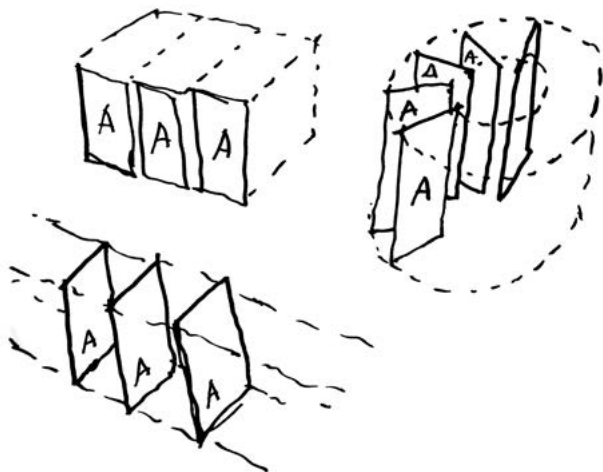
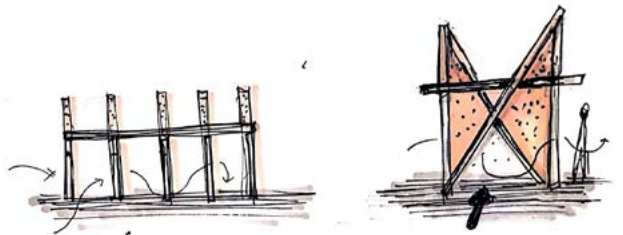

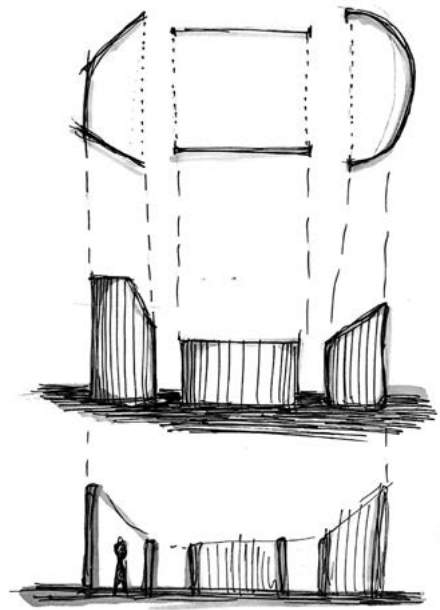
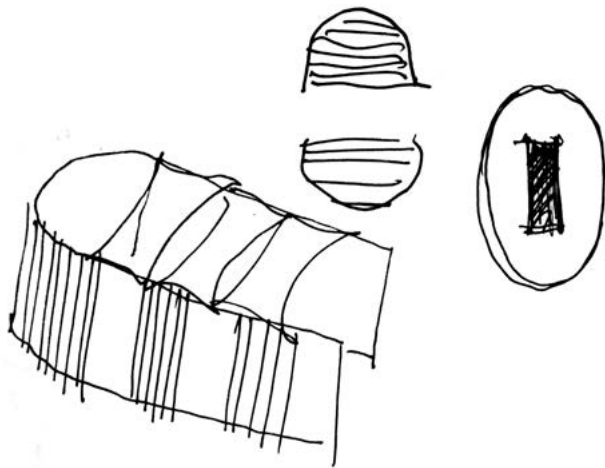

ideas

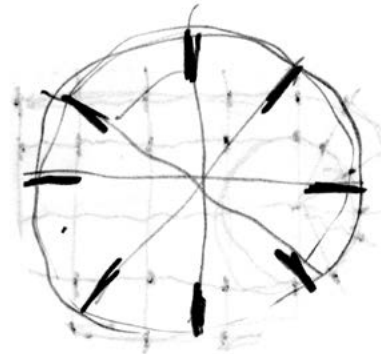
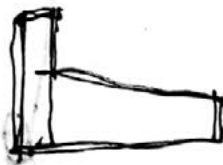
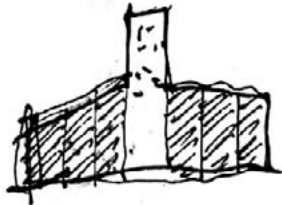
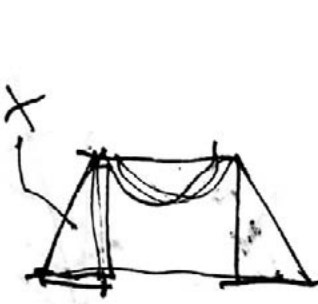
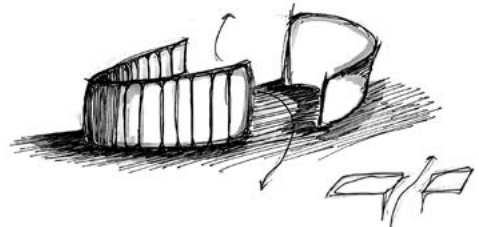
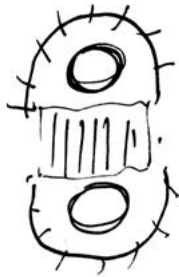

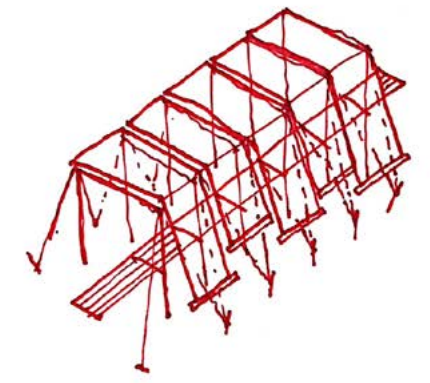
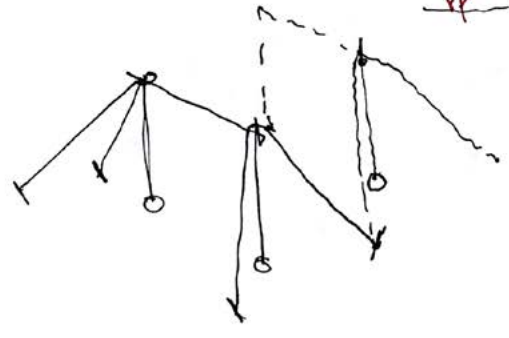
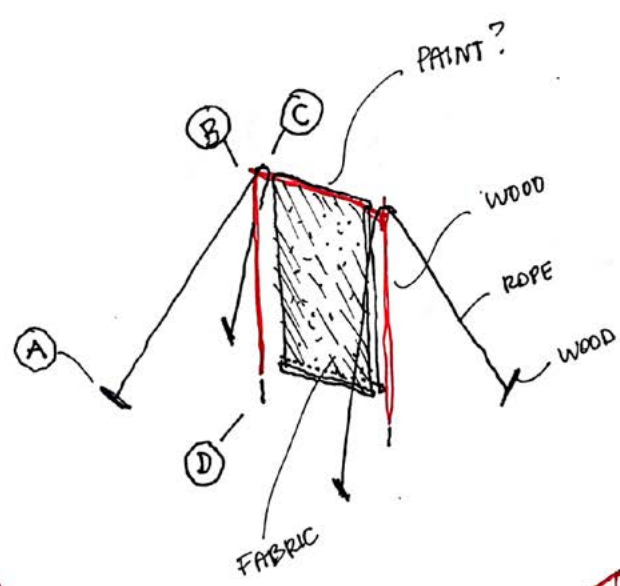
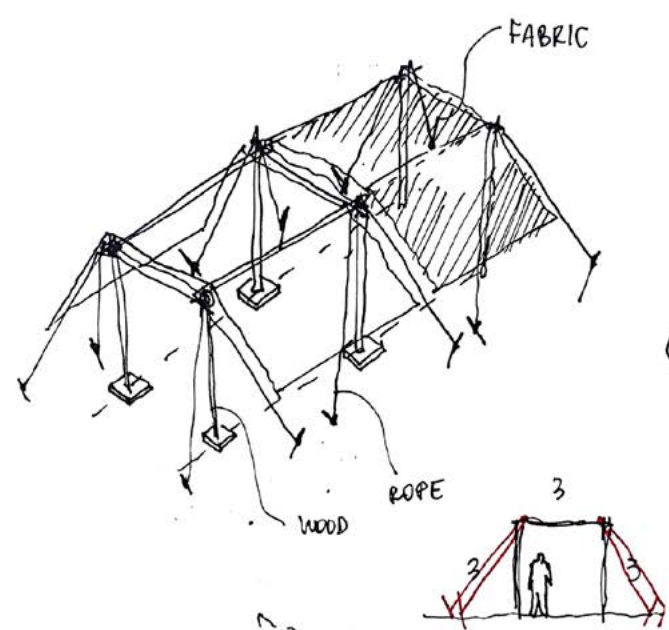
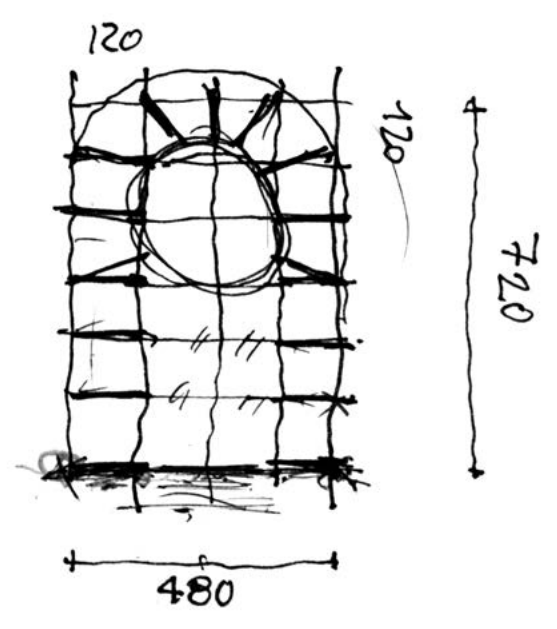
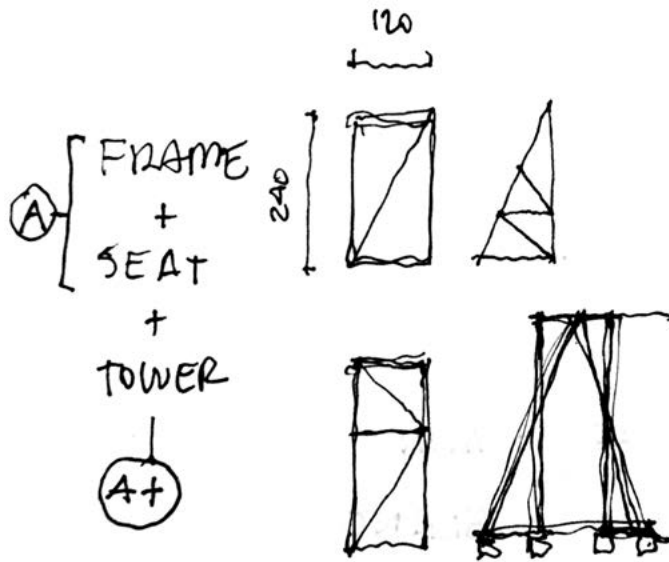

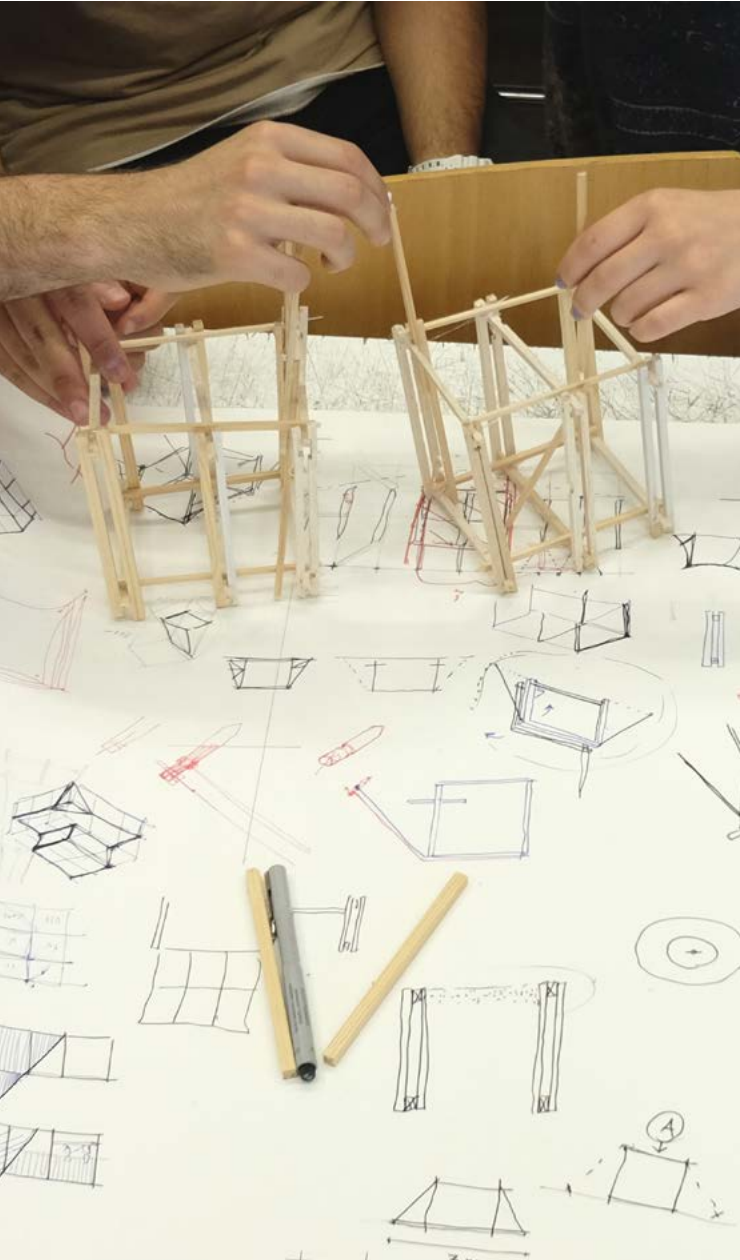

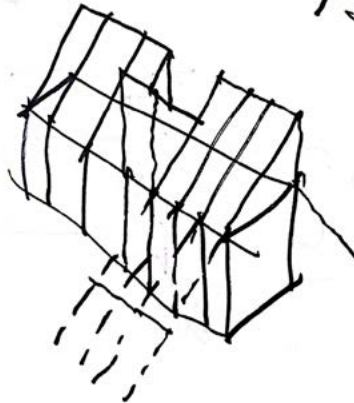
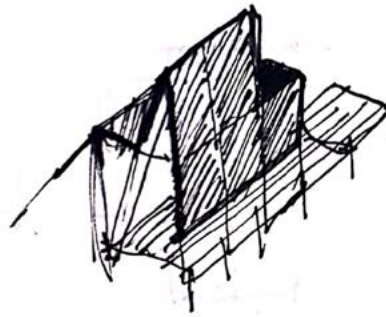
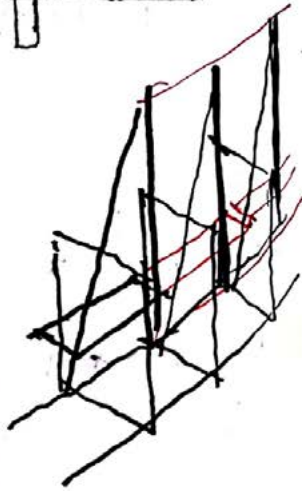
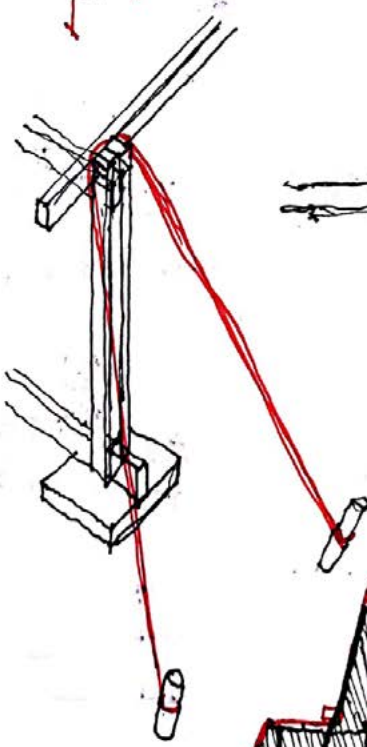
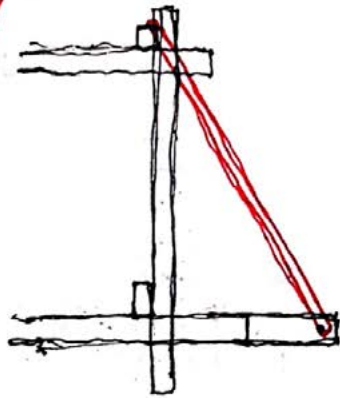
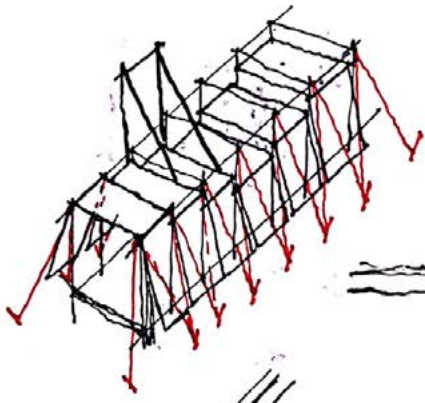

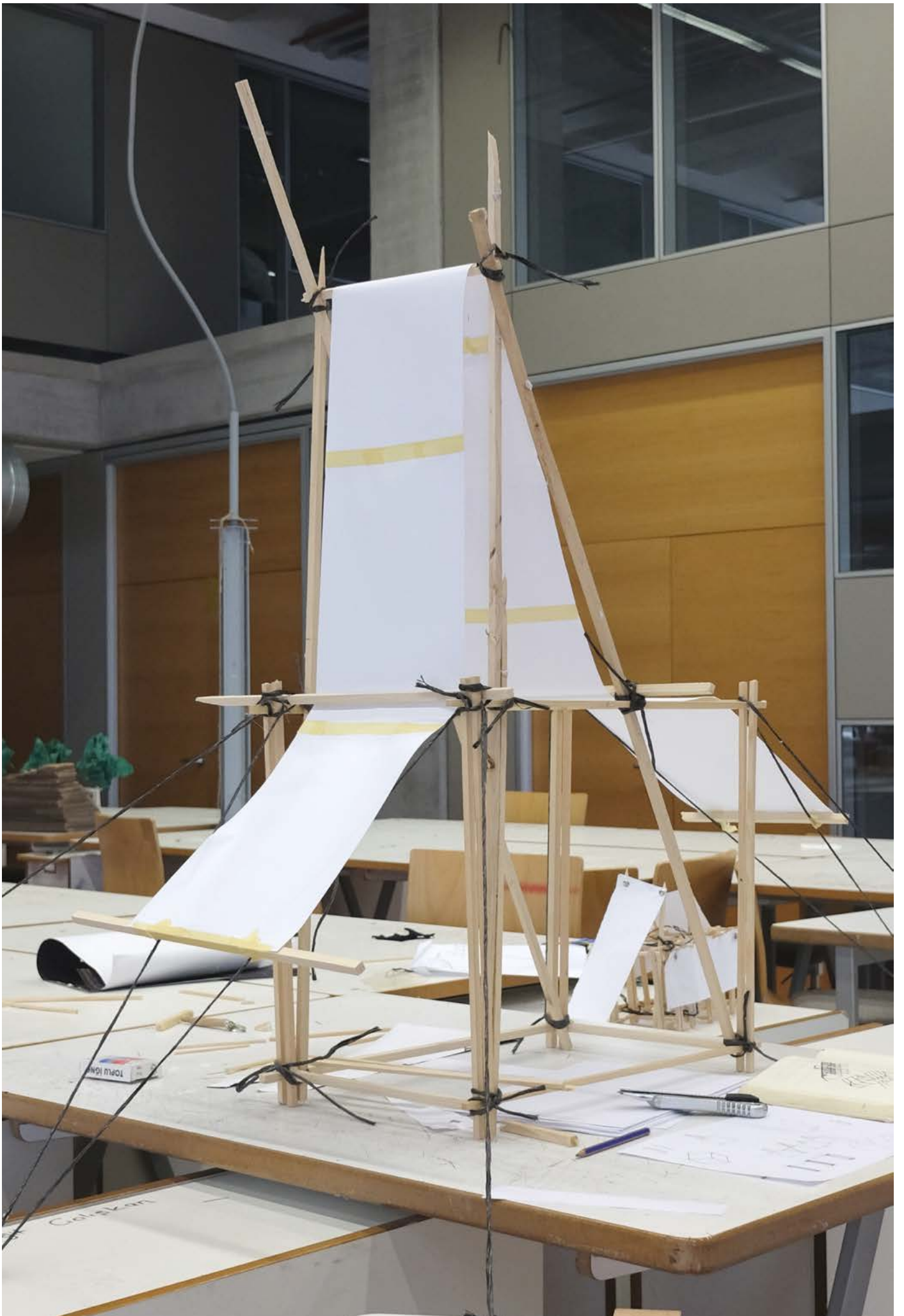

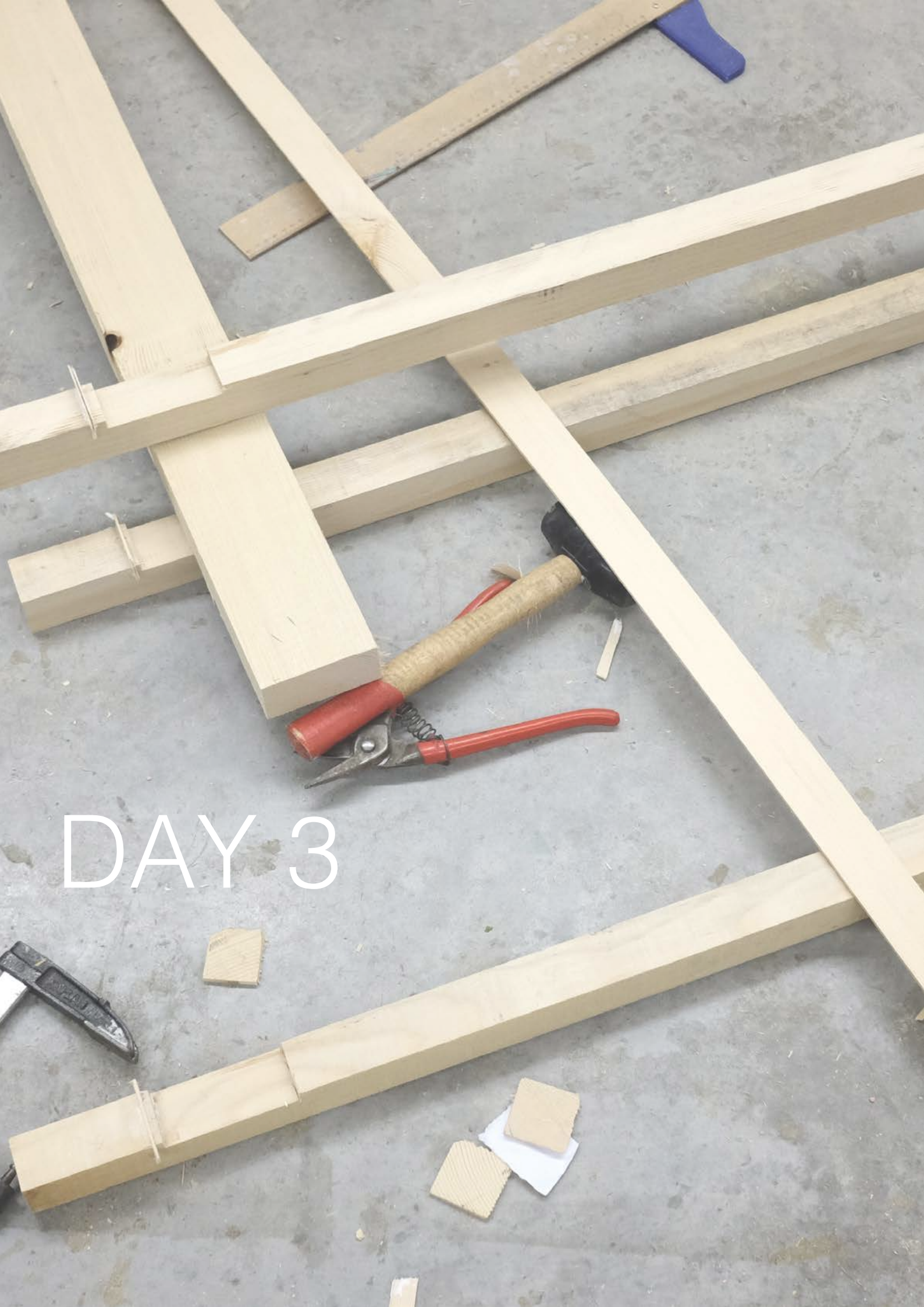

DAY 3

Day three was the first day **at the workshop.**

It was fully dedicated to preparing the parts that would later be assembled into frames. Teams of two or three were established for mark-up, drilling and cutting and joinery.







DAY 4

A strategic decision was made at the beginning of the day: **to install the structure at site alternative 02**, given its proximity to the workshop and the unpredictable possibilities of having to repair mistakes -or eventually to produce new pieces to reinforce the structure-, all this in a 35-degree summer day atmosphere.

Parts were assembled into frames, frames were put up and attached between each other with beams. A first test was done at the end of the day to ensure the dimensioning of the fabric.





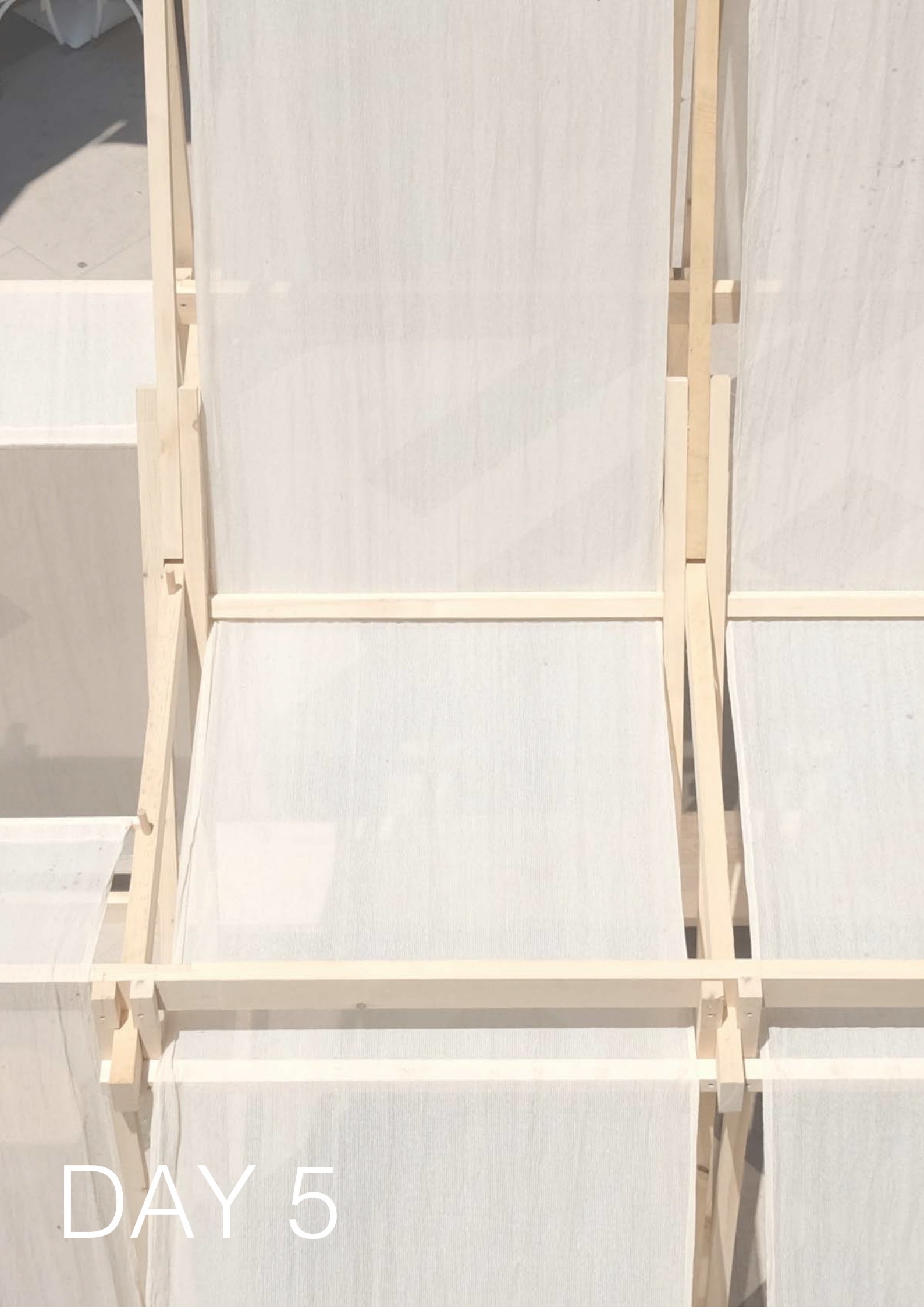

DAY 5

With the collaboration of the fashion department, the **agriculture mesh** was dimensioned in length, reinforced on the sides and pockets where added to its extremes to hold sticks that where to be sustained with cords, and then attached to cellular concrete blocks for tension.

A bench was built-in to the structure and then a final group discussion was held inside Geçit to celebrate the accomplishment of this intense 5-day experience.

***Geçit** was the name the students wanted to give to the structure once it had been built. It's a Turkish word meaning portal, passage or gateway

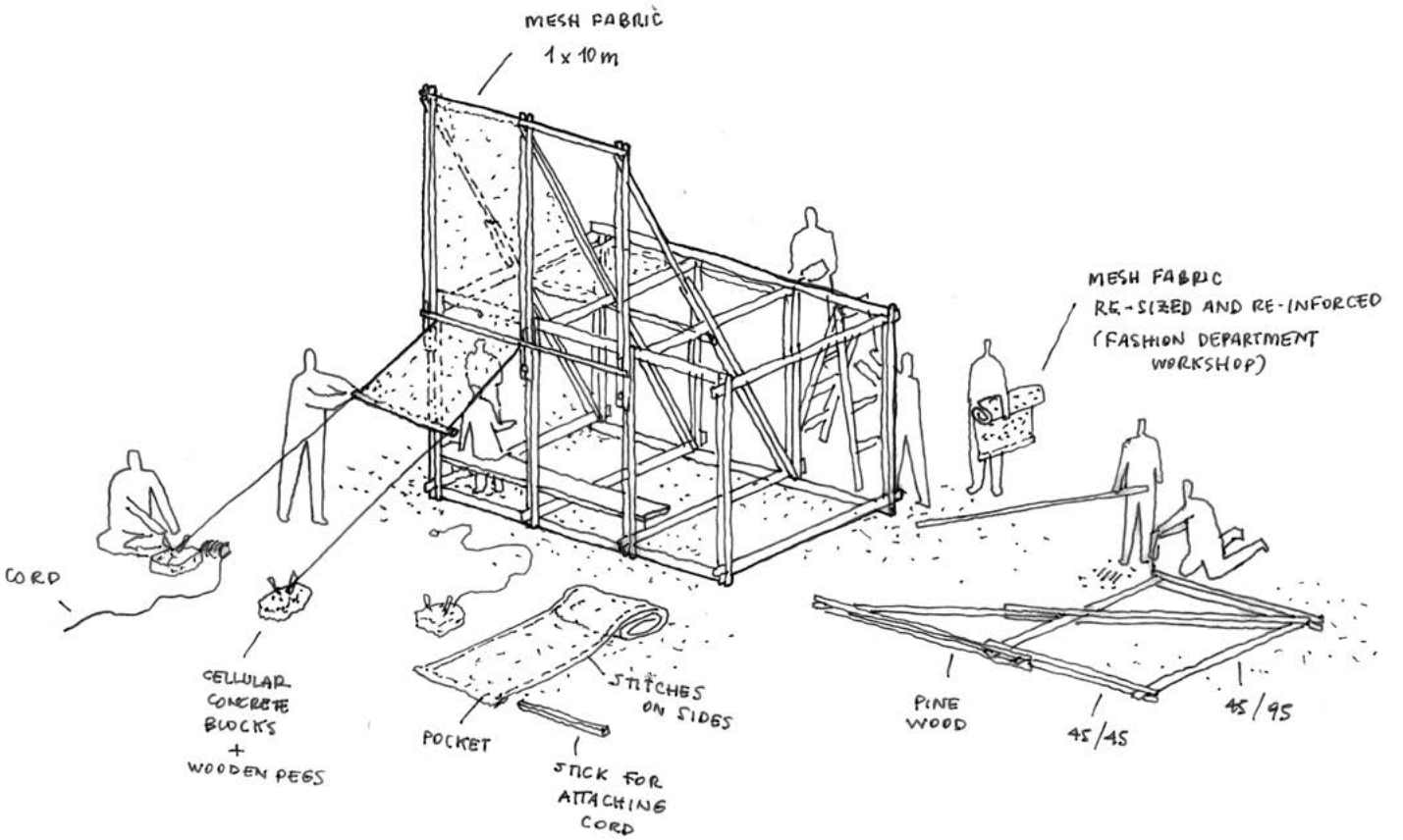

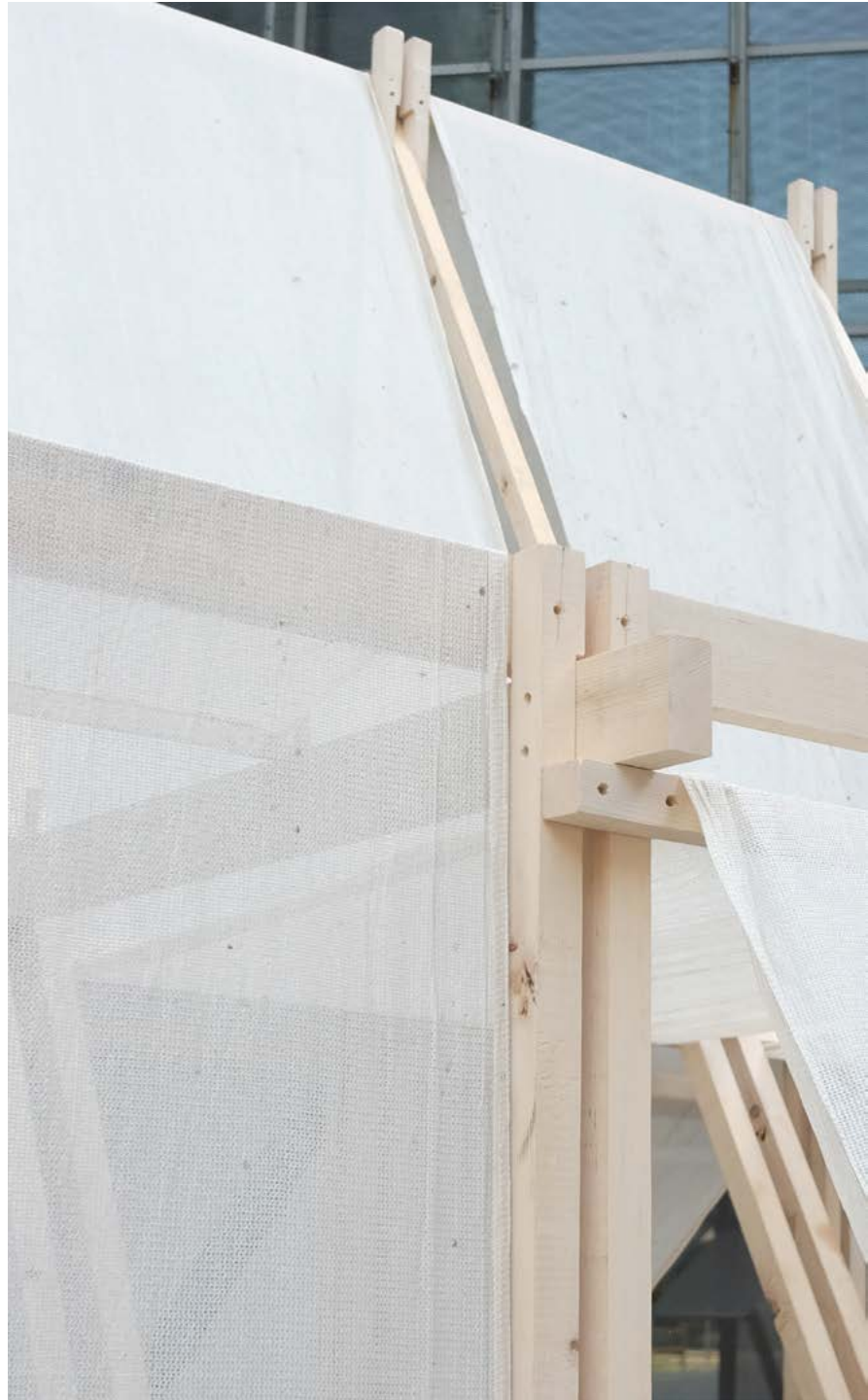











geçit

students

Melis Özbaş, Büşra Nalbantlar,
Selen Erdoğan, Anil Dinç
Demirbilek, Serkut Yüksel, Oğul
Görgülü, Beste Çiçek

tutors

Stefano Pugliese and Sebastian
Erazo

Faculty of Fine Arts and Design
Izmir Ekonomi Universitesi
Izmir, Turkiye

photos

Sebastian Erazo

group photo

Ersan çelikaş

References

photos Pabellon CCP

Gino Zavala Bianchi

photos Grooming retreat

Mariana de Delás

Gartnerfuglen Arkitekter

wood design and construction workshop

10-14 June 2019

Concept and design 2 days

Build 3 days

Materials

- pine wood (x40) 45x95mm ;
3m (length); untreated
- reclaimed agriculture mesh fabric,
white 3.5m x 11m
- cord 10m
- Cellular concrete blocks (randomly
broken) + 18mm wooden pegs
- 300 screws ; pz1 4x8, 4x12